



MANHOLES - VENTED

MODEL

Top-Entry, Round Atmospheric Vented CIP Manhole

PRINCIPLE

This top-entry manhole allows individuals to enter a tank. It is designed as an atmospheric application with a vented lid.

APPLICATION

The atmospheric manhole is mounted on the top dome or cone of stainless steel tanks. It allows the tank to vent during emptying and filling.

FEATURES

- Top-entry
- Grade 304L and 316L stainless steel
- Internal splash ring
- Round, black plastic handle
- Hinged lid

OPTIONS

Available in grade 304L and 316L stainless steel.
Available with a 430mm diameter neck.





MANHOLES - VENTED

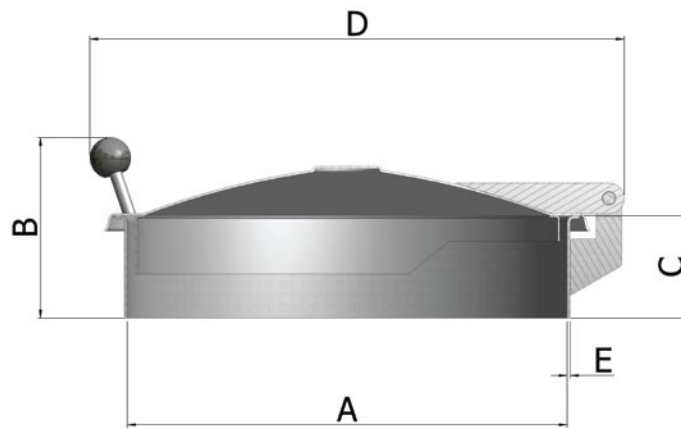

DIMENSIONS

MODEL	A	B	C	D	E	MWP	MWV	WEIGHT
511-2-100	430	201	100	558	3	0kPa	0kPa	9kg

MWP = Maximum Working Pressure

MWV = Maximum Working Vacuum

All measurements in millimeters (mm)

Contact us on +27 11 674 1300/3 for more information.

The information contained in this brochure is for guidance only. BMC Engineering reserves the right to modify any material or feature without advance notice. For further information please consult our web site.

www.bmceng.co.za

 **BMC Engineering**